

Masimo Sensors

RD SET[®]

Featuring Masimo SET[®] Measure-through Motion and Low Perfusion[™] Technology

Now with Improved
SpO₂ Accuracy for
All Patients

- > Maximising Patient Comfort
- > Optimising Clinician Workflow
- > Helping Hospitals Meet Their Green Initiatives 

 MASIMO

RD SET Sensors for Patients

MAXIMISING PATIENT COMFORT

Lightweight sensor with a flat, soft cable

> FLAT SENSOR CABLE

- > Flat, lightweight sensor cable with smooth edges lies comfortably on the patient's hand or foot

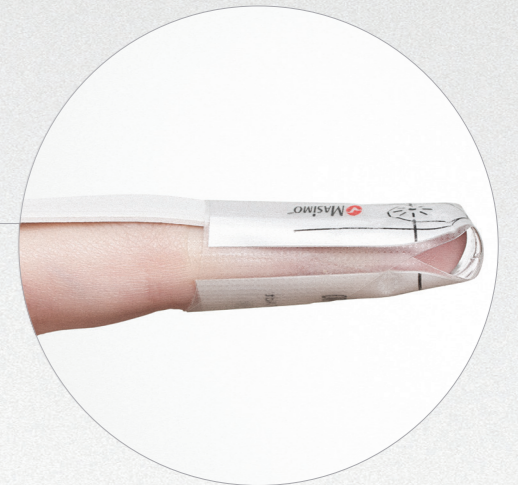

> LIGHTWEIGHT CONNECTOR



> SMALL, THIN OPTICAL COMPONENTS

- > Low profile internal components allow the sensor to better conform to the shape of a finger and may put less pressure on the measurement site
- > Orientation of optical components position the sensor cable comfortably on top of the hand



Tape removed for illustrative purposes

RD SET Sensors for Caregivers

OPTIMISING CLINICIAN WORKFLOW

Simple to use with enhanced connection and sensor application features for a better user experience

> TWO STYLES OF SENSORS FOR USE ON DIFFERENT PATIENT TYPES



Wrap-around Style Sensors

- > Available in adult, paediatric, infant, and neonatal sizes
- > Easily removed and reapplied
- > Suited for patients with long fingernails or finger deformities

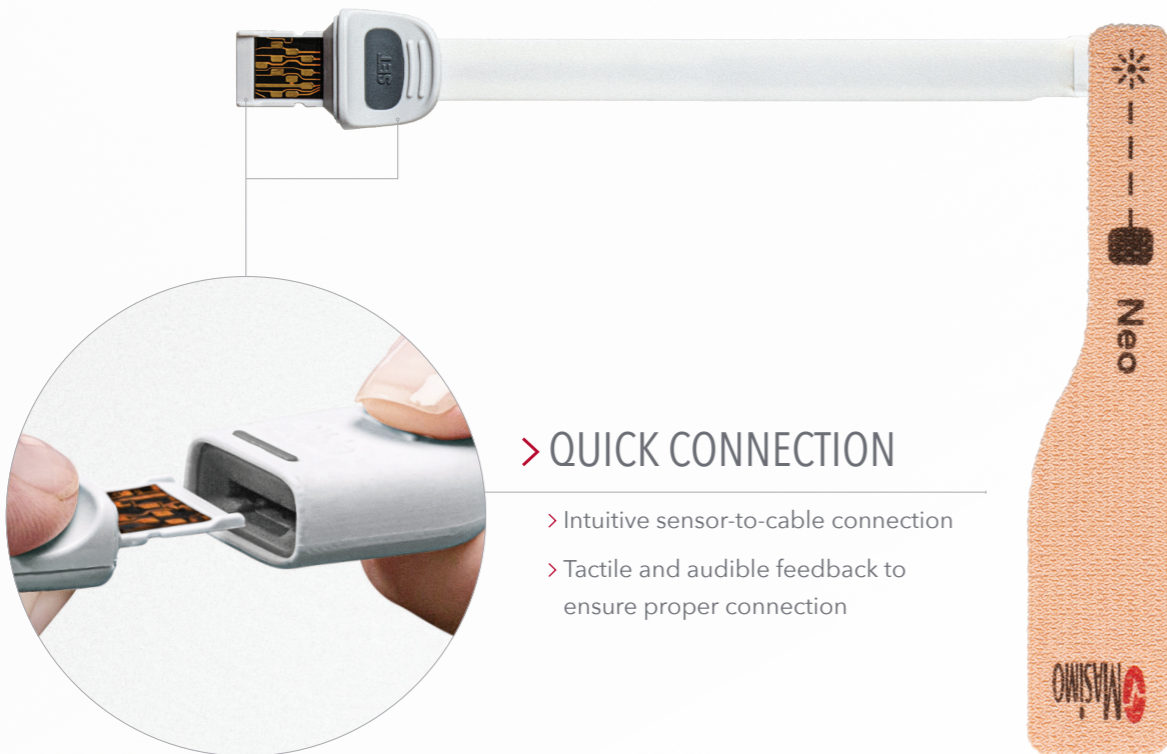

> QUICK CONNECTION

- > Intuitive sensor-to-cable connection
- > Tactile and audible feedback to ensure proper connection

SpO₂ accuracy has improved in conditions of motion and no motion, providing clinicians with greater confidence when monitoring oxygenation status.



Fold-over Style Sensors

- > Available in adult and paediatric sizes
- > Offer a more secure application to the digit and more intuitive sensor alignment



> SENSOR GRAPHICS TO GUIDE PROPER SENSOR APPLICATION

- > Application graphics printed on top and bottom of sensors to assist with sensor application for optimal performance and ease of sensor removal and reapplication
- > Sensor labels to immediately communicate location of emitter/detector



RD SET Sensors for the Environment

HELPING HOSPITALS MEET THEIR GREEN INITIATIVES

The same Masimo SET® performance with a significant reduction in waste

> SENSOR MATERIALS

> Lightweight sensor results in less material waste



RD SET Adt Sensor

Lighter than traditional cable-based sensors

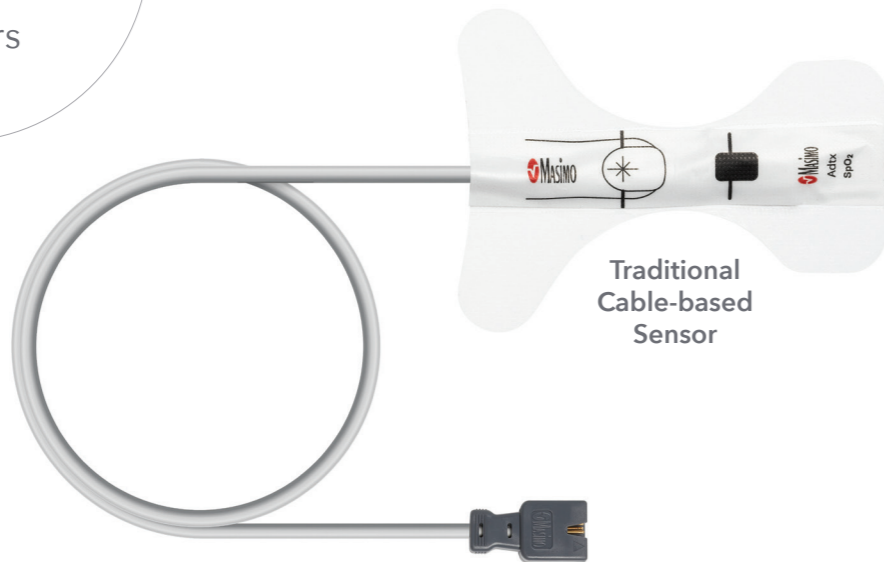

Traditional Cable-based Sensor

> PACKAGING DESIGN

- > RD SET sensors utilise significantly smaller packaging
- > Lightweight package design is easy to handle

Sleek recyclable packaging reduces storage space by 44%*

*Storage space reduction calculated by dividing the reduction in volume by volume of the traditional cable-based sensor box.

Volume: 181.25 inches³ (460.375 cm³)



Traditional Cable-based Sensor Box
Box of 20

Volume: 100.48 inches³ (255.22 cm³)



RD SET Sensor Box
Box of 20

> LIGHTWEIGHT SENSOR AND PACKAGING DESIGN FOR A GREEN SOLUTION

Up to 84% less waste with Adult RD SET sensors versus traditional cable-based sensors**

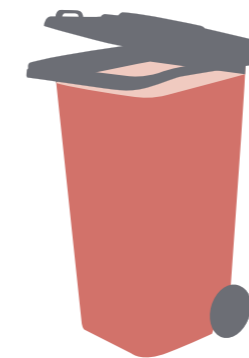

Traditional Cable-based Sensors

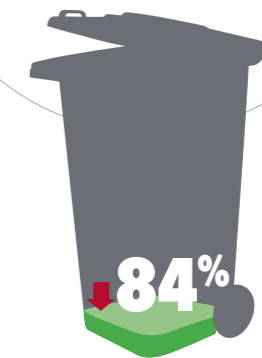

RD SET Sensors

**Waste calculated by comparing the sensor and packaging weight of traditional cable-based sensors versus Adult RD adhesive sensors. Internal data on file.

APPLICATION



RD SET Adt
finger application



RD SET Pdt
finger application



RD SET Inf
thumb application



RD SET Neo
foot application



RD SET NeoPt /
NeoPt-500
foot application

DISPOSABLE SENSORS

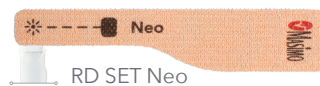
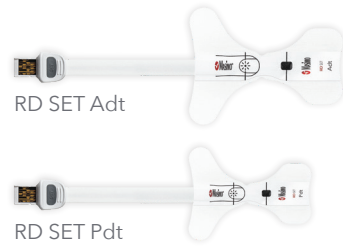

Masimo's Softouch line of sensors is designed to be used whenever skin sensitivity issues are a concern, such as with extremely low birth weight infants. Masimo Softouch sensors incorporate soft foam and VelAid hook and loop attachment wraps that come in a variety of configurations to address a wide range of clinical uses.

RD SET DISPOSABLE SENSOR SERIES SPECIFICATIONS

ACCURACY	COMPATIBILITY																										
<p>RD SET Adt/ Pdt/ Inf/ Neo/ NeoPt/ NeoPt-500 (ARMS)¹</p> <p>SpO₂ Accuracy Range..... 70–100%</p> <p>No Motion 1.5%</p> <p>Motion 1.5%</p> <p>Low Perfusion2%</p> <p>PR Accuracy</p> <p>No Motion 3 bpm</p> <p>Motion 5 bpm</p> <p>Low Perfusion 3 bpm</p> <p>SpO₂ Limits of Agreement (LoA)</p> <p>Upper 95% LoA (no motion) 2.3%</p> <p>Lower 95% LoA (no motion) -2.3%</p> <p>Upper 95% LoA (motion) 2.9%</p> <p>Lower 95% LoA (motion) -2.2%</p>	<p>Compatible Oximeters Systems containing Masimo SET® or licensed to use RD SET Series sensors²</p>																										
	INFORMATION																										
	Single-patient-use / Non-sterile / Packaged 20 per box / Does not contain natural rubber latex																										
	ORDERING INFORMATION																										
	<table border="0"> <thead> <tr> <th>RD SET Disposable Sensor Series</th> <th>Part Number</th> </tr> </thead> <tbody> <tr> <td>RD SET Adt</td> <td>4000</td> </tr> <tr> <td>RD SET Pdt</td> <td>4001</td> </tr> <tr> <td>RD SET Inf</td> <td>4002</td> </tr> <tr> <td>RD SET Neo</td> <td>4003</td> </tr> <tr> <td>RD SET NeoPt</td> <td>4004</td> </tr> <tr> <td>RD SET NeoPt-500</td> <td>4005</td> </tr> </tbody> </table> <table border="0"> <thead> <tr> <th>RD SET Replacement Tapes/Wraps</th> <th>Part Number</th> </tr> </thead> <tbody> <tr> <td>Replacement Tapes, Inf</td> <td>4046</td> </tr> <tr> <td>Replacement Tapes, Neo</td> <td>4047</td> </tr> <tr> <td>Replacement Wraps, NeoPt</td> <td>4048</td> </tr> <tr> <td>Replacement Wraps, NeoPt-500</td> <td>4094</td> </tr> <tr> <td>Replacement Tapes, Neo, Large</td> <td>4674</td> </tr> </tbody> </table>	RD SET Disposable Sensor Series	Part Number	RD SET Adt	4000	RD SET Pdt	4001	RD SET Inf	4002	RD SET Neo	4003	RD SET NeoPt	4004	RD SET NeoPt-500	4005	RD SET Replacement Tapes/Wraps	Part Number	Replacement Tapes, Inf	4046	Replacement Tapes, Neo	4047	Replacement Wraps, NeoPt	4048	Replacement Wraps, NeoPt-500	4094	Replacement Tapes, Neo, Large	4674
RD SET Disposable Sensor Series	Part Number																										
RD SET Adt	4000																										
RD SET Pdt	4001																										
RD SET Inf	4002																										
RD SET Neo	4003																										
RD SET NeoPt	4004																										
RD SET NeoPt-500	4005																										
RD SET Replacement Tapes/Wraps	Part Number																										
Replacement Tapes, Inf	4046																										
Replacement Tapes, Neo	4047																										
Replacement Wraps, NeoPt	4048																										
Replacement Wraps, NeoPt-500	4094																										
Replacement Tapes, Neo, Large	4674																										
	PARAMETERS SUPPORTED																										
	Oxygen Saturation (SpO ₂) Pulse Rate (PR) Perfusion Index (Pi) Pleth Variability Index (PVi®) Respiration Rate from the Pleth (RRp®)																										
WEIGHT RANGE																											
RD SET Adt	>30 kg, finger or toe application																										
RD SET Pdt	10–50 kg, finger or toe application																										
RD SET Inf	3–10 kg, thumb or great toe application																										
RD SET Neo (neonatal)	<3 kg, hand or foot application																										
RD SET Neo (adult)	>40 kg, finger or toe application																										
RD SET NeoPt	<1 kg, hand or foot application																										
RD SET NeoPt-500	<1 kg, hand or foot application																										

¹ ARMS accuracy is a statistical calculation of the difference between device measurements and reference measurements. Approximately two-thirds of the device measurements fell within \pm ARMS of the reference measurements in a controlled study. ² Accuracy specifications provided reflect use with the following Masimo technology boards and software versions and higher: MS-2000 SB version V5.1, MSX-1 version V5.3, MX-5 version V7.12.

For professional use. See instructions for use for full prescribing information, including indications, contraindications, warnings, and precautions.

Masimo U.S.
Tel: 1 877 4 Masimo
info-america@masimo.com

Masimo International
Tel: +41 32 720 1111
info-international@masimo.com

